

ALUMA-FORM, Inc.
 3625 OLD GETWELL ROAD,
 MEMPHIS, TN 38118-6072 U.S.A.
 TEL (901) 362-0100 FAX (901) 375-3383

DUPLICATION, DISTRIBUTION OR ALTERATION OF THIS DOCUMENT BY ANY MEANS, IN WHOLE OR IN PART, IS STRICTLY FORBIDDEN. ALL INFORMATION HEREIN DISCLOSED, WHETHER PATENTABLE OR OTHERWISE, IS THE CONFIDENTIAL, PROPRIETARY AND INTELLECTUAL PROPERTY OF ALUMA-FORM, INC. ANY USE OR PUBLICATION OF THIS DOCUMENT OR CONTAINED INFORMATION, WITHOUT FIRST OBTAINING EXPLICIT WRITTEN AUTHORIZATION FROM ALUMA-FORM, INC., IS ABSOLUTELY FORBIDDEN.

30009
 PART NUMBER

B
 REVISION

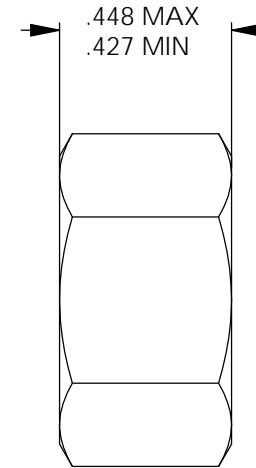
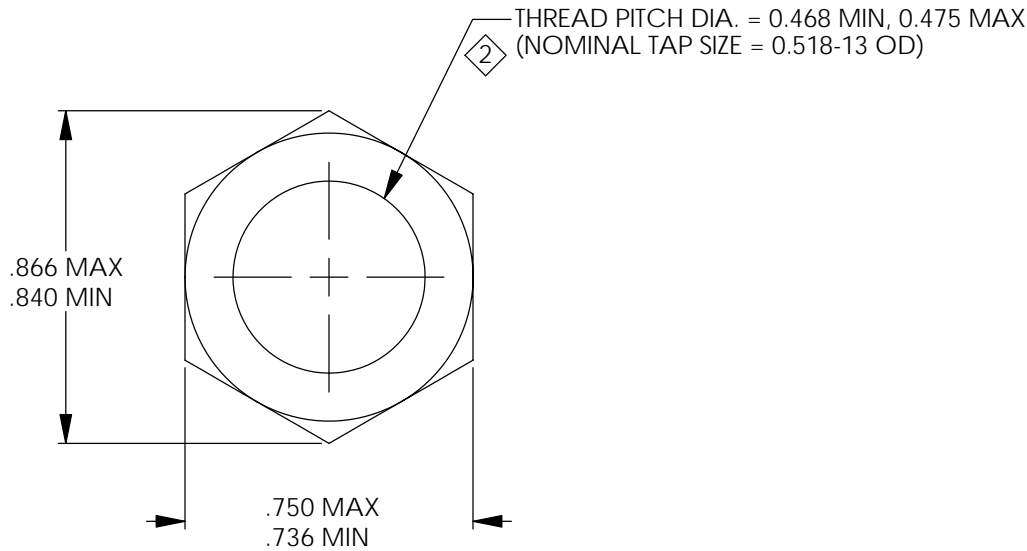
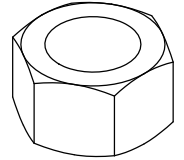

1 1/2"-13 UNC HEX NUT - TAPPED .018 OVERSIZED
 MUST CONFORM TO ALUMA-FORM SPECIFICATION #90005

CHANGE / REVISION DESCRIPTION			E. A. NO.	CHANGE DATE	- RELEASE E. A. PROJECT CODE 28-APR-67 RELEASE DATE 2:1 SCALE - WEIGHT .037#	DESCRIPTION	NUT, HEX, 1/2" (.018 OS) 1		
						MATERIAL	GALV. STEEL PER ANSI C135.1		
2 WAS THREAD PITCH DIA. = .470 MIN., .476 MAX						SECTION #	-		
2 WAS (NOMINAL TAP SIZE = 0.520-13 OD)						CARLISLE	30009 PART NUMBER B REVISION		
1 WAS .020 OS			3618	23-JAN-07		DRAWN BY			